

Powr-Rib® Edgewound

Edgewound Round Wire Power Resistors

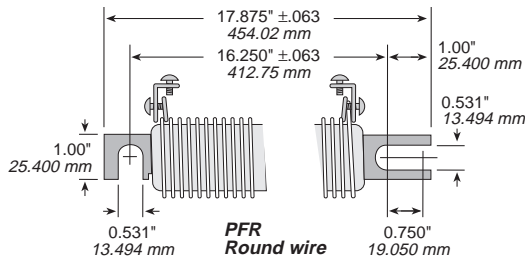

Terminal 2172B (30 amps & more)

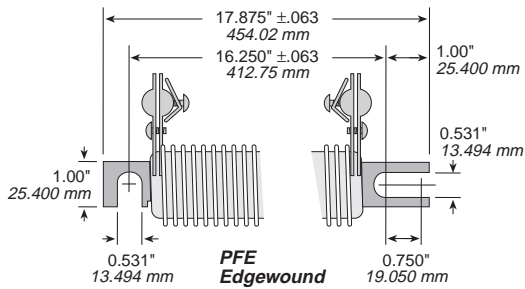
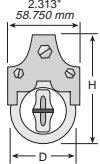

Terminal 2172G (29 amps & less)

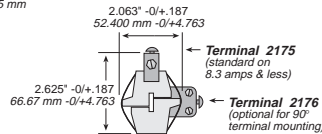
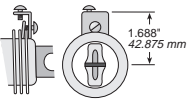

Designed in both Edgewound and Round Wire formats, these rugged resistors can handle 700 to 1000 Watts of power. Specify our edgewound design for very low resistance and high power capacity. When higher resistance with lower power capacity is required use our round wire design.

Constructed of a heavy resistance alloy mounted on ceramic insulators and supported by a metal mounting bracket. Metal parts, except for the resistance element, are heavily plated to prevent oxidation at high operating temperatures and to prevent corrosion. The mounting bar is slotted on each end to facilitate installation. Edgewound units provide clamp-type terminals, permitting a reliable connection which can be moved along the resistive element to obtain intermediate values.

SPECIFICATIONS

Electrical

Current Rating: Continuous duty as listed on page 43.

Wattage Rating: 700 to 1,000 (up to 1,600 watts on special order)

Resistance Tolerance: ±10% standard, ±5% available

Terminals: Clamps, movable along resistor wire for setting intermediate resistance values on Edgewound units (current must be derated in proportion).

Temperature Coefficient:

±300 ppm/°C for resistors 50 amps and more

±500 ppm/°C for resistors 47 amps or less

Ohmic Values: See chart on page 43.

Mounting: Metal mounting bar is slotted on each end to facilitate installation.

Edgewound units have clamp-type terminals which permits a reliable connection and can be moved along the resistive element to obtain intermediate values.

Ordering Information

See Part Number chart for standard resistance values when ordering.

STOCK PART NUMBERS FOR STANDARD RESISTANCE VALUES

Ohms	Part #	Amps	Ohms	Part #	Amps
Edgewound					
0.1	⊕ PFE5KR100	100	2.2	⊕ PFE5K2R20	18.4
0.12	⊕ PFE5KR120	91	2.8	⊕ PFE5K2R80	16.3
0.14	✓ PFE5KR140	89	3.5	⊕ PFE5K3R50	14.6
0.16	⊕ PFE5KR160	78	4.5	⊕ PFE5K4R50	12.7
0.18	⊕ PFE5KR180	75	5.4	⊕ PFE5K5R40	11.8
0.22	✓ PFE5KR220	68	6.8	⊕ PFE5K6R80	10.3
0.25	⊕ PFE5KR250	63	8.5	⊕ PFE5K8R50	9.4
0.3	⊕ PFE5KR300	57	Roundwire		
0.33	✓ PFE5KR330	54	11	⊕ PFR5K11R0	8.3
0.37	⊕ PFE5KR370	50	13	✓ PFR5K13R0	7.6
0.5	⊕ PFE5KR500	47	17	✓ PFR5K17R0	6.6
0.6	✓ PFE5KR600	43	20	⊕ PFR5K20R0	5.9
0.67	✓ PFE5KR670	41	25	⊕ PFR5K25R0	5.1
0.75	⊕ PFE5KR750	39	⊕ = Most popular stock values		
1	⊕ PFE5K1R00	33	✓ = Stock values		
1.3	⊕ PFE5K1R30	29	⊕ = Non-stock values subject to minimum handling charge per item.		
1.6	⊕ PFE5K1R60	26			

ORDERING INFORMATION

PFE5KR100

PFE = Edgewound
 PFR = Roundwire
 # of Sections: 2 5, 3 6, 4 7, 8
 Tolerance: K = 10%
 Ohms: R100 = 0.10, 1R00 = 1.0, 10R0 = 10

080 AND 030 TYPES EDGEWOUND "POWR-RIB" RESISTORS

Size* (Number of Insulator-Segments Long)

	2	3	4	5	6	7	8
	8.875 (225.425) A	11.875 (30.163) A	14.875 (377.825) A	17.875 (454.025) A	20.875 (530.225) A	23.875 (606.425) A	26.875 (682.625) A
	7.250 (184.150) B	10.250 (31.750) B	13.250 (336.550) B	16.250 (412.75) B	19.250 (488.950) B	22.250 (565.150) B	25.250 (641.350) B
Max. Amps	Ohms	Ohms	Ohms	Ohms	Ohms	Ohms	Ohms
100	.033	.057	.080	.100	.120	.140	.160
91	.040	.070	.100	.120	.140	.160	.180
89	.046	.078	.110	.140	.170	.200	.230
78	.052	.088	.120	.160	.190	.220	.250
75	.060	.100	.140	.180	.210	.250	.300
68	.070	.120	.180	.220	.260	.300	.340
63	.080	.130	.190	.250	.300	.350	.400
57	.100	.160	.230	.300	.360	.420	.480
54	.110	.180	.250	.330	.400	.470	.540
50	.120	.200	.280	.370	.450	.530	.610
47	.170	.280	.380	.500	.600	.700	.800
43	.210	.330	.460	.600	.720	.850	.980
41	.230	.360	.510	.670	.800	.930	1.06
39	.260	.420	.580	.750	.900	1.05	1.20
33	.350	.560	.770	1.00	1.20	1.40	1.60
29	.450	.730	1.00	1.30	1.50	1.75	2.00
26	.560	.900	1.20	1.60	1.90	2.20	2.50
18.4	.690	1.20	1.70	2.20	2.70	3.10	3.50
16.3	.880	1.50	2.20	2.80	3.40	4.00	4.60
14.6	1.10	1.90	2.70	3.50	4.30	5.10	5.90
12.7	1.40	2.40	3.50	4.50	5.50	6.50	7.50
11.8	1.70	2.90	4.20	5.40	6.60	7.80	9.00
10.3	2.10	3.70	5.30	6.80	8.30	9.80	11.3
9.4	2.70	4.60	6.50	8.50	10.40	12.3	14.2

082 and 032 Types Round-Wire POWR-RIB Resistors

8.3	3.4	5.9	8.5	11.0	13.5	16.0	18.5
7.6	4.1	7.1	10.0	13.0	15.9	18.8	21.7
6.6	5.3	9.2	13.0	17.0	20.8	24.6	28.4
5.9	6.3	10.9	15.4	20.0	24.5	29.0	33.5
5.1	7.9	13.6	19.3	25.0	30.7	36.4	42.1

*Order other sizes, or variations, by length, and ohms. Two terminals supplied as standard unless otherwise specified.

**Section 5 units are stocked and are ordered by catalog number.